

NOTES

Do not scale this drawing.
 All dimensions to be checked and verified on site.
 This drawing is to be read in conjunction with all other relevant drawings and specifications.
 Any discrepancies in the drawings are to be reported immediately to Christopher Rodgers.
 This drawing is not to be used for construction or sales purposes unless marked 'issued for construction'.
 Dimensions and area schedules are subject to change.

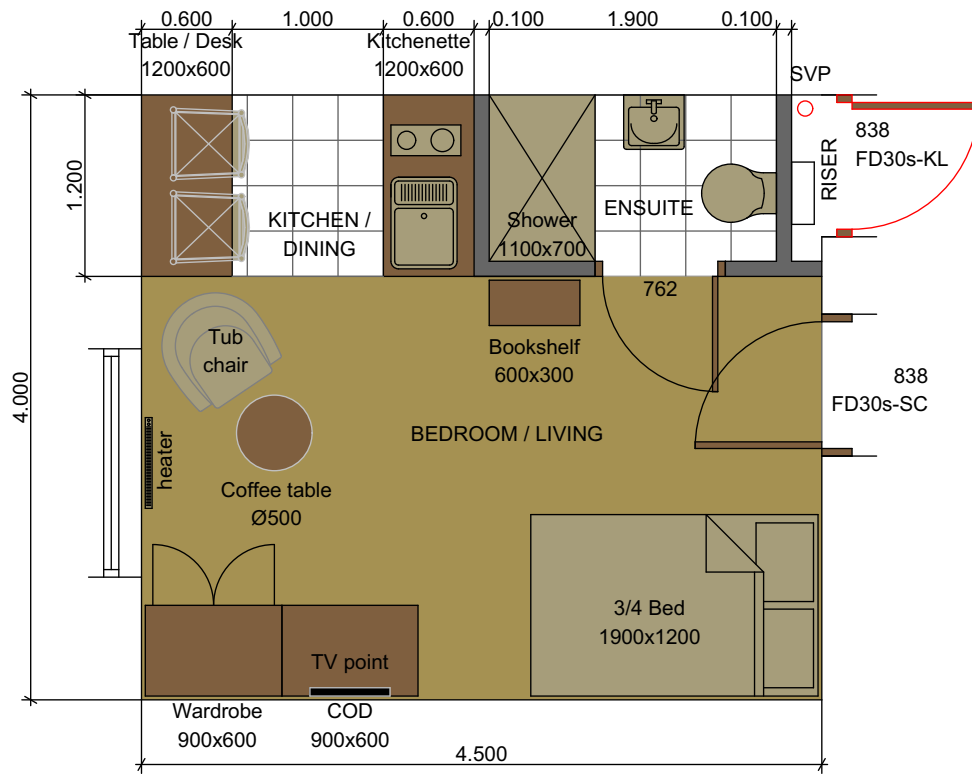

TYPICAL 18M2 SELF-CONTAINED STUDENT APARTMENT

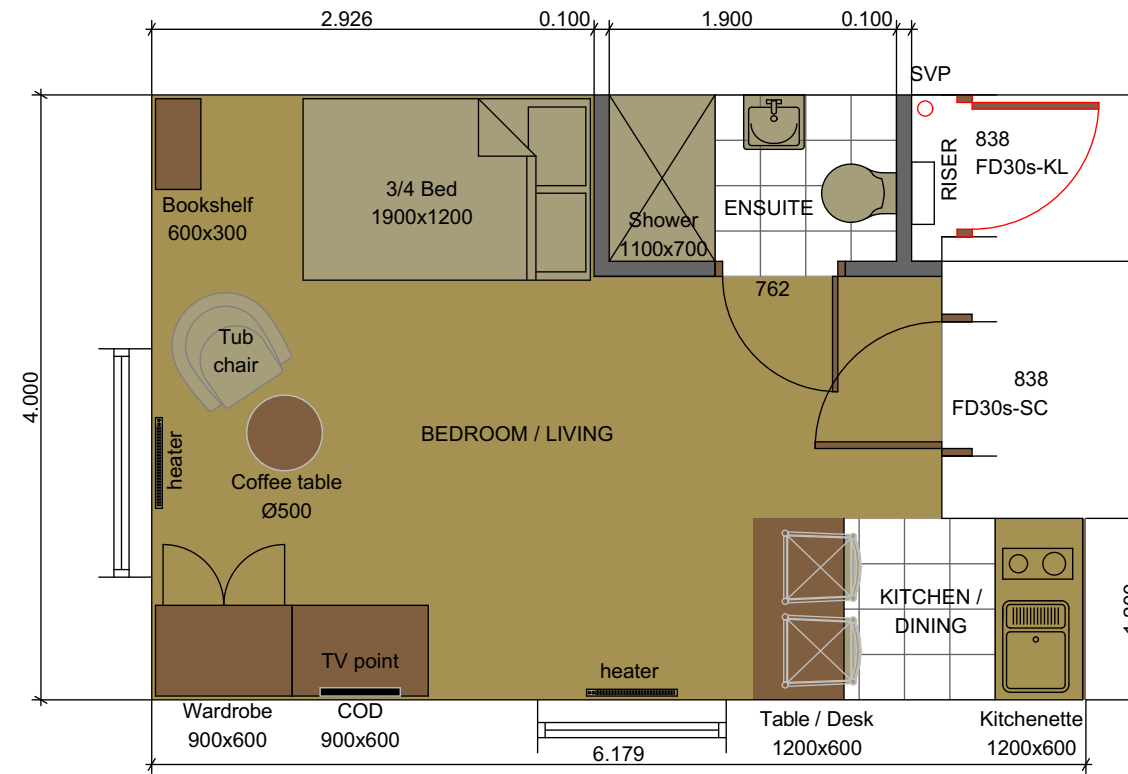

TYPICAL 21M2 SELF-CONTAINED STUDENT APARTMENT

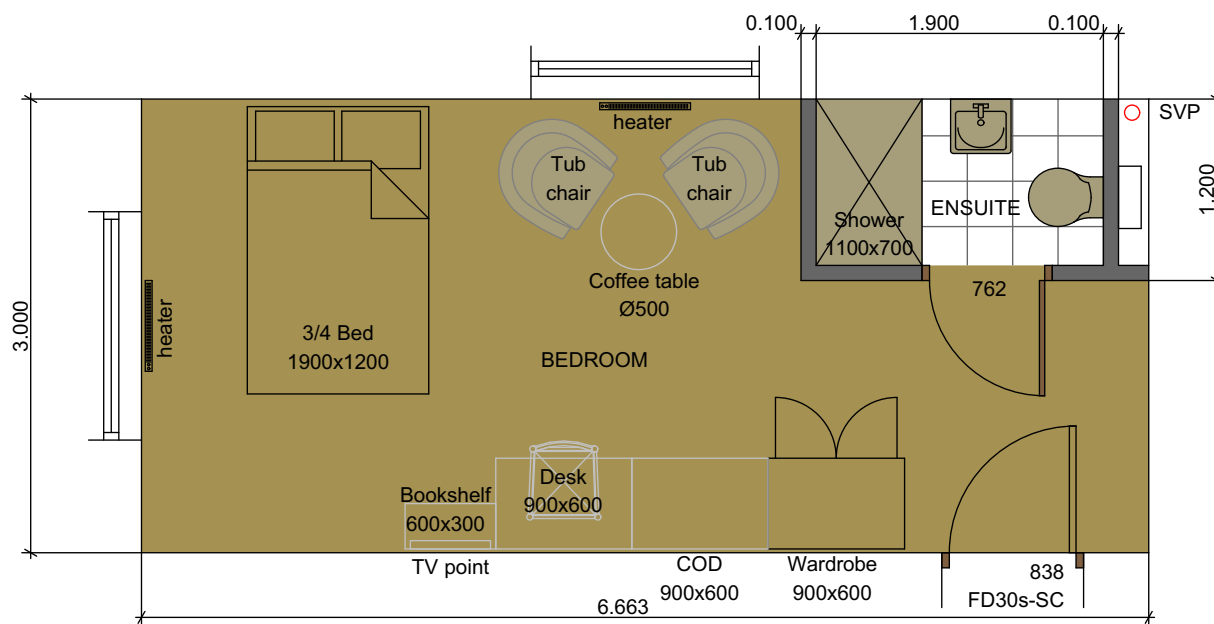

TYPICAL 20M2 STUDENT BEDROOM WITHIN CLUSTER APARTMENTS

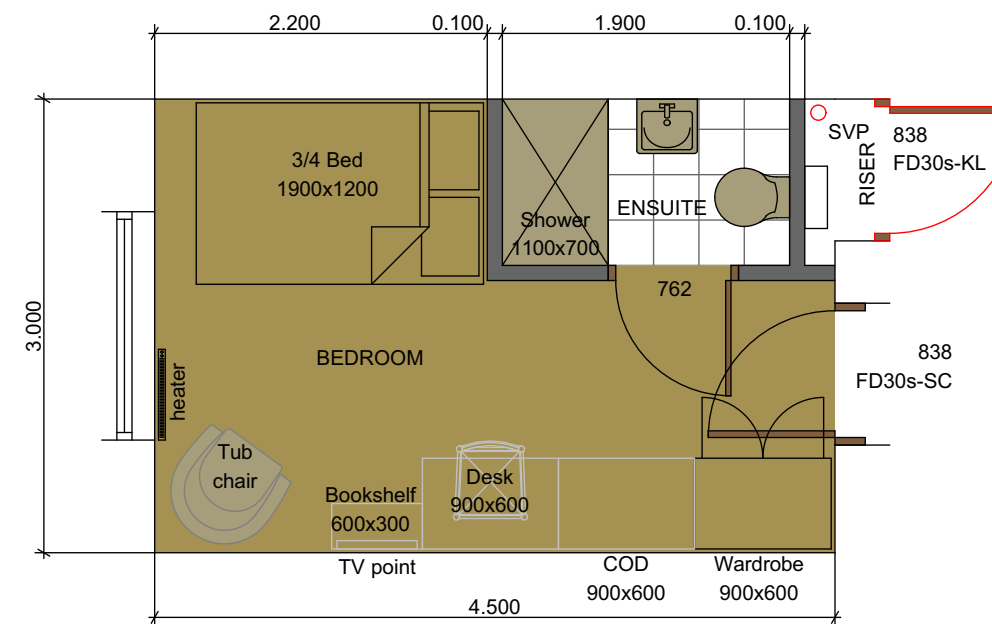

TYPICAL 13.5M2 STUDENT BEDROOM WITHIN CLUSTER APARTMENTS

Rev	By	Date	Description
C	MH	Aug 16	Addition of self-contained apartments.
#	MH	May 15	Planning application submission
P4	MH	Mar 15	Revisions following Pre-application enquiry consultations with the planning officer
P3	MH	Feb 15	Design development
P2	MH	Jan 15	Design development
P1	MH	Jan 15	Preliminary design

Client:
Kingscrown Properties Limited

Project:
 Proposed Student Accommodation at
 Euston road, Bangor
 Gwynedd, LL57 2YP

Drawing:
Proposed Indicative Apartment Plans

Project No:	Drawing No:	Revision:
1109	07	C

Issue:
PLANNING APPLICATION

Scale: 1:100 @ A1; 1:200 @ A3 Drawn: MH
 Date: January 2015 Checked: CR

CHRISTOPHER RODGERS

Project Management • Architecture • Quantity Surveying

CR&A Limited, Suite A9, Allied Business Centre
 Potter Place, Skelmersdale, WN8 9PW
 Tel: 07710 560133
 e-mail: c.rodgers@chrisrodgers.co.uk

CR&A Limited Registered in England and Wales No. 7070122